

One of the **isomass** systems range

isocheck™

27C, 23C & 14C Systems



OVERLAY PLATFORM SYSTEM FOR CONCRETE FLOORS

- New build
- Refurbishments
- Conversions
- Robust detail compliant



Taking the *mystery* out of Acoustics

DESCRIPTION

- Isocheck 27C, 23C & 14C systems are designed to reduce airborne sound transmission and also reduce impact sound transmission through concrete floors.
- Isocheck 27C & 23C consist of a 5.5 mm layer of cross linked Isopoli bonded to 22mm and 18mm P5 V313 moisture resistant chipboard respectively, whereas isocheck 14C consists of a 5.5 mm layer of cross-linked Isopoli bonded to 9mm moisture resistant medium density fibreboard.
- When installed as part of a complete party floor construction it enables a concrete floor to meet the sound transmission standards of ADE 2003 and subsequent amendments in 2004, 2010, 2013 & 2015.

APPLICATIONS

- To be used over concrete floors for new build projects, refurbishments and conversions.



Isocheck 23C



Product data

Overall size:	Isocheck 27C	2400mm x 600mm x 27mm
	Isocheck 23C	2400mm x 600mm x 23mm
	Isocheck 14C	1200mm x 600mm x 14mm
Resilient layer:	5.5mm Isopoli cross linked foam	
Weight:	Isocheck 27C	22.8kg per sheet
	Isocheck 23C	18.8kg per sheet
	Isocheck 14C	5.15kg per sheet

Performance (on the constructions illustrated)

Treated floor with:	$D_{nT,W} + C_{tr}$	$L'_{nT,W}$	
Isocheck 27C	53dB	54dB	Complies with New Build Robust Detail descriptive
Isocheck 23C	53dB	53dB	FFT5 within E-FC-1, E-FC-2 and E-FS-1.
Isocheck 14C	51dB	52dB	

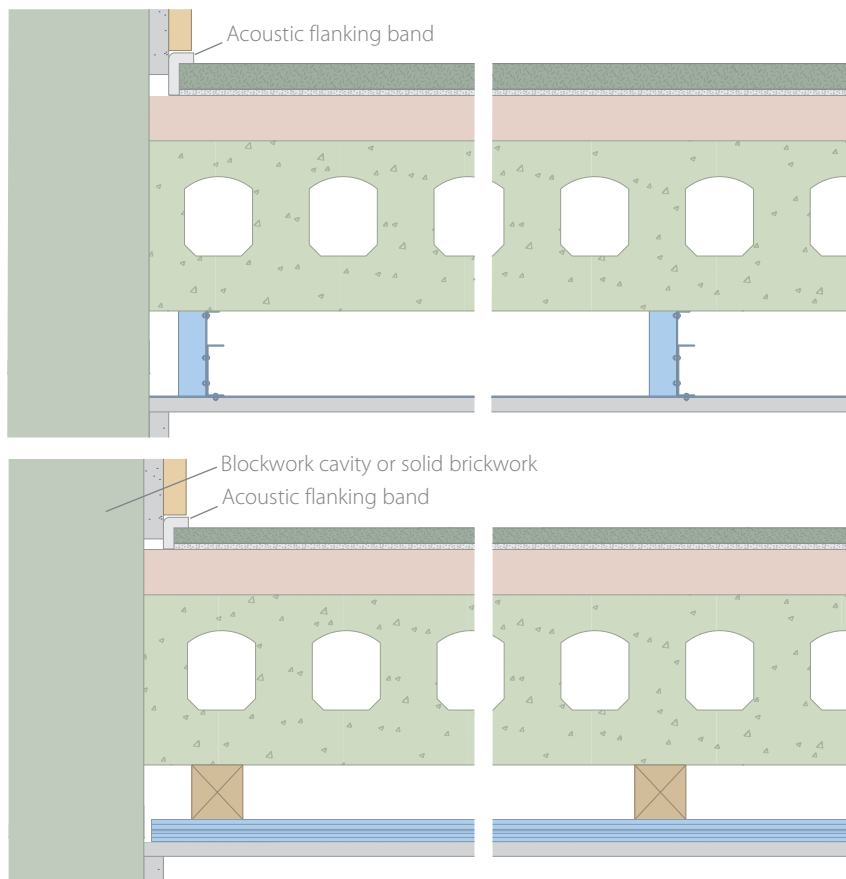

- ❑ Isocheck 27C, 23C or 14C.
- ❑ $\geq 300\text{kg/m}^2$ hollow core concrete with 80kg/m^2 sand/cement screed or 40mm screed.
- ❑ min. 75mm void formed by metal frame suspended ceiling system with $\geq 10\text{kg/m}^2$ gypsum board ceiling (top) **or**
- ❑ 50 x 75mm timber battens.
- ❑ $\geq 10\text{kg/m}^2$ gypsum board ceiling supported on resilient bars @ 400mm centres, perpendicular to the battens min 75mm below underside of sub-floor.

Every effort has been taken in the preparation of this sheet to ensure the accuracy of representations contained herein. Recommendations as to the use of materials, construction details and methods of installation are given in good faith and relate to typical situations. However, every site has different characteristics and reliance should not be placed upon the foregoing recommendations. Advice can be given as to specific applications of the products, upon request to isomass building products.

www.isomass.co.uk
www.monodeck.co.uk

SPECIFICATION

The acoustic floor shall be:

- ❑ Isocheck 27C, 23C or 14C system, supplied by Isomass Ltd. Units 10 & 11, Avenue Business Park, Elsworth, Cambridgeshire CB23 4EY and installed in accordance with manufacturer's instructions / recommendations.

INSTALLATION

- ❑ Lay isocheck 27C, 23C or 14C over dry level screed, in brick bond pattern, applying Isocheck adhesive to all tongued and grooved panel joints.
- ❑ Apply isocheck Acoustic Angled Flanking Band on the edges of the Isocheck boards just before they are pushed against the perimeter walls to isolate the board from the wall.
- ❑ Install skirting and trim off excess Flanking Band.
- ❑ May also be installed in conjunction with underfloor heating systems.
- ❑ Full installation instructions are available and must be used in conjunction when laying this floating floor system.

For advice on treatment of services and penetrations, contact us, consult our brochure or visit our website.